

Rooflight with pleated blind and net
for installation in caravans and mobile homes



Model 46P / 4600P



Technical data:

Aperture	400 x 400 mm
Roof thickness	24-56 mm
Corner radius	23 mm
Site dome	560 x 560 mm
Height over roof	92 mm
Ventilation	150 cm ²
Weight	3,0 kg
Size inner frame	565 x 530 x 35 mm
Outer frame material	Polypropylene
Dome material	Polypropylene
Speed limit	130 km/h
Authorization	ECE R43 -019649

EN Installation and Operating Instructions

Please read the instructions carefully before installing the rooflight and store it for future.



We cannot be held responsible for incorrect fitting, handling or operation. Any product faults relating to the production and materials used should be notified to us via an authorised dealer immediately.

Included with delivery

- 1x Rooflight with outer frame
- 1x Inner frame with double pleats
- 1x Fixing parts (8x fixing brackets and 4x large plastic screw)

Additionally required for installation (not included in delivery)

- 1x Elastic sealant adhesive, e.g. Dekalin Dekaseal 8936 or SikaLastomer®-710
- 8x Fixing screws for the upper frame
- Pan 3,5 mm / head according to DIN ISO 7049 / Length acc. to table

Roof thickness	mm	24-34	31-41	37-47	44-54	51-56
Screw length	mm	25	32	38	45	50

- With timber support under the roof lining: 4x Fixing screws for the inner frame:
- Pan 3,5 mm / head according to DIN ISO 7049 (DIN 7981) / length max. 10 mm

Explanation of symbols



NOTE

Particularly important information.



ATTENTION!

Failure to observe can lead to material damage.



WARNING!

Safety note: Serious risk of injury.

Safety and installation instructions

- Check the roof thickness of your vehicle before mounting.
- **The rooflight should only be fitted to a flat roof surface, both internally and externally.**
- Choose a fitting position that will not interfere with other roof mounted components (e.g. roof-racks/antenna's etc.) and avoid internally installed electrical cables and furniture, which could impede the correct operation of the rooflight.
- Always fit the rooflight with the handles facing in the direction of travel (i.e. handles at the front and rear)
- Never stand on the dome of the rooflight!
- Do not open the rooflight while driving. The rooflight must be locked down before traveling.
- Do not open the rooflight in strong wind or rain .
- Close the rooflight during rain and snowfall.

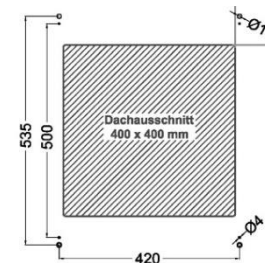

Inner frame

Extras (optional)

Designation	Article No.
Adapter frame for Fiat Ducato	4040ARW

Installation



Please clean the frames carefully before mounting the sealant. Remove dirt, grease, oil or release agents from the assembly area.



! Follow the instructions of the sealant manufacturer.

Separate the inner and outer frames and fit the outer frame to the outside of the roof aperture onto a bed of sealant. **The operating handles facing the front and rear of the vehicle!**

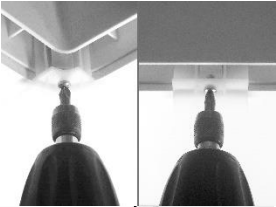

Place over the screw holes on the inside of the frame, the 8 fixing brackets; four in each corner, four in the centre of each side. Secure with screws, stop as soon as the brackets start to distort.

! Max. Torque 0.5 Nm.

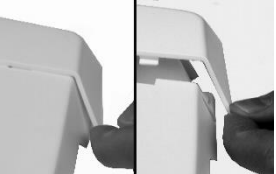

To fit the inner frame, gently pull out the pointed ends of the cover profiles to release them and reveal the fixing points.

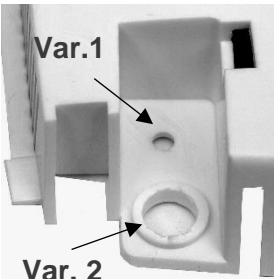

Version 1: Timber support under the roof lining

Offer up the inner frame into the outer frame. Use the four small holes to fix the inner frame with standard screws into the timber support.

Version 2: Inner lining made of plywood / polyester layer

Offer up the inner frame into the outer frame and mark drill holes (large screw hole). Pre-drill the screw holes and screw the inner frame tight with the supplied plastic screws.



Refit the inner frame covers by locating the securing lugs and keeping the covers parallel against the roof whilst sliding them carefully onto the frame, 'clicking' back into position, without distorting.

Operation

To open the rooflight, press both locking buttons and push the handles upwards. The rooflight can be opened fully by the handles or in four different directions, so that the dome can be angled against driving weather conditions.

To close the rooflight, press the locking buttons again and pull the handles down. The rooflight is locked.

- !** Keep the pleated blinds open while driving to avoid driving noise and damage from the airstream.
- To avoid heat accumulation do not close blind completely during the day. Open both pleats when not using the vehicle.

Cleaning

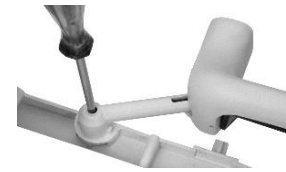

For easier cleaning of the dome it can be removed from the frame by releasing the four screws holding the handle arms.

! Never remove the screws holding the dome and the handles together. These are secured by a torque screwdriver and should only be handled by an approved dealer.

Use only clear water and a soft sponge.

! Solvents may attack the plastic and make it brittle.

Clean the gaps by immersing the hood in a container filled with water. Let the dirt soak a little. Use the two handles to pull the hood through the water so that the dirt can be washed out.

! Make sure that only the original screws are used when replacing the dome and they enter the thread in the plastic correctly. Do not over-tighten.

Clean the pleated blinds with a soft brush, dry cloth or feather duster.

! We strongly advise against wet cleaning, as this can damage the insect screen and blackout pleated blind.

Warranty

The legal warranty applies.

Disposal

Dispose of packaging material and product in accordance with local legal regulations and regulations for the disposal of plastics.

MPK Metall- und
Plastikverarbeitung GmbH & Co. KG
Friedrich-Ebert-Str. 298-300
D-58566 Kierspe
mpk-rooflights.com

